

**Letters of Consent:**

- 1) **Owners of Freehold:** IDA Ireland, Athlone Business and Technology Park, Garrycastle, Dublin Road, Athlone, Co. Westmeath.
- 2) **Owners of Long Lease:** Amazon Data Services Ireland Limited (ADSIL), One Burlington Plaza, Burlington Road, Dublin 4.

The Secretary  
An Bord Pleanála  
64 Marlborough Street  
Dublin 1

Date: 15th September 2020

### **WITHOUT PREJUDICE**

**Re: Proposed Planning Application by CAP Developments LLC for the Construction of a HV Substation at IDA Business & Technology Park, Drogheda, Co. Meath.**

#### **To Whom it may Concern**

I wish to confirm that IDA Ireland, as freehold registered owner of the IDA Business & Technology Park, Drogheda, Co. Meath, has reviewed the proposed drawings, namely CAP-CSE-00-XX-DR-C-2130.

IDA notes that CAP Developments LLC is proposing to apply for planning approval for the above on IDA lands. IDA has reviewed the planning drawings, as prepared by Clifton Scannell Emerson Associates, Consulting Engineers of Mentec House (1st Floor), Bakers Point, Pottery Road, Dun Laoghaire, Co. Dublin, A96 K6P3, and has no objection in principle to the proposal, subject to the following conditions: -

1. CAP Developments LLC, or any other party, are not permitted to commence construction on IDA lands until the said IDA lands are legally in their ownership and formal consent to commencement of the proposed works is granted by IDA.
2. Compliance with regulations and obtaining approval of all public, local and other authorities.
3. Obtaining planning permission and complying with conditions.
4. Compliance with Building Regulations.

5. Compliance with the rights of lessees and occupiers of adjoining and surrounding properties. In this regard proposals for construction, access and parking must be agreed with IDA in advance.
6. The re-instatement to the satisfaction of IDA, of any damaged areas/services adjoining the proposed development in the ownership of IDA or its clients.
7. IDA Ireland to be notified of proposed commencement and completion dates for the proposed development.

Please note that this is a mere consent to the inclusion of the lands for the purpose of the planning application and is not intended, nor shall it be deemed or construed, to be an agreement on IDA's part to sell or transfer any interest in the lands to CAP Developments LLC, or any other party.

This letter of consent is valid only for the purpose of CAP Developments LLC making an application to the appropriate planning authority for the above development.

Yours faithfully



---

Emer Croghan  
Assistant Property Executive  
Strategic Property Management Division  
IDA Ireland



RATHMULLAN  
Ráth Maoláin



DRAWING IS PRODUCED USING THE  
IRISH TRANSVERSE MERCATOR (ITM)  
GEOGRAPHIC COORDINATE SYSTEM

A1

LEGEND:

- ADSIL OWNERSHIP BOUNDARY LINE
- PROPOSED PLANNING APPLICATION LINE
- IDA OWNERSHIP LAND
- PROPOSED LOCAL SUPPLY DUCT

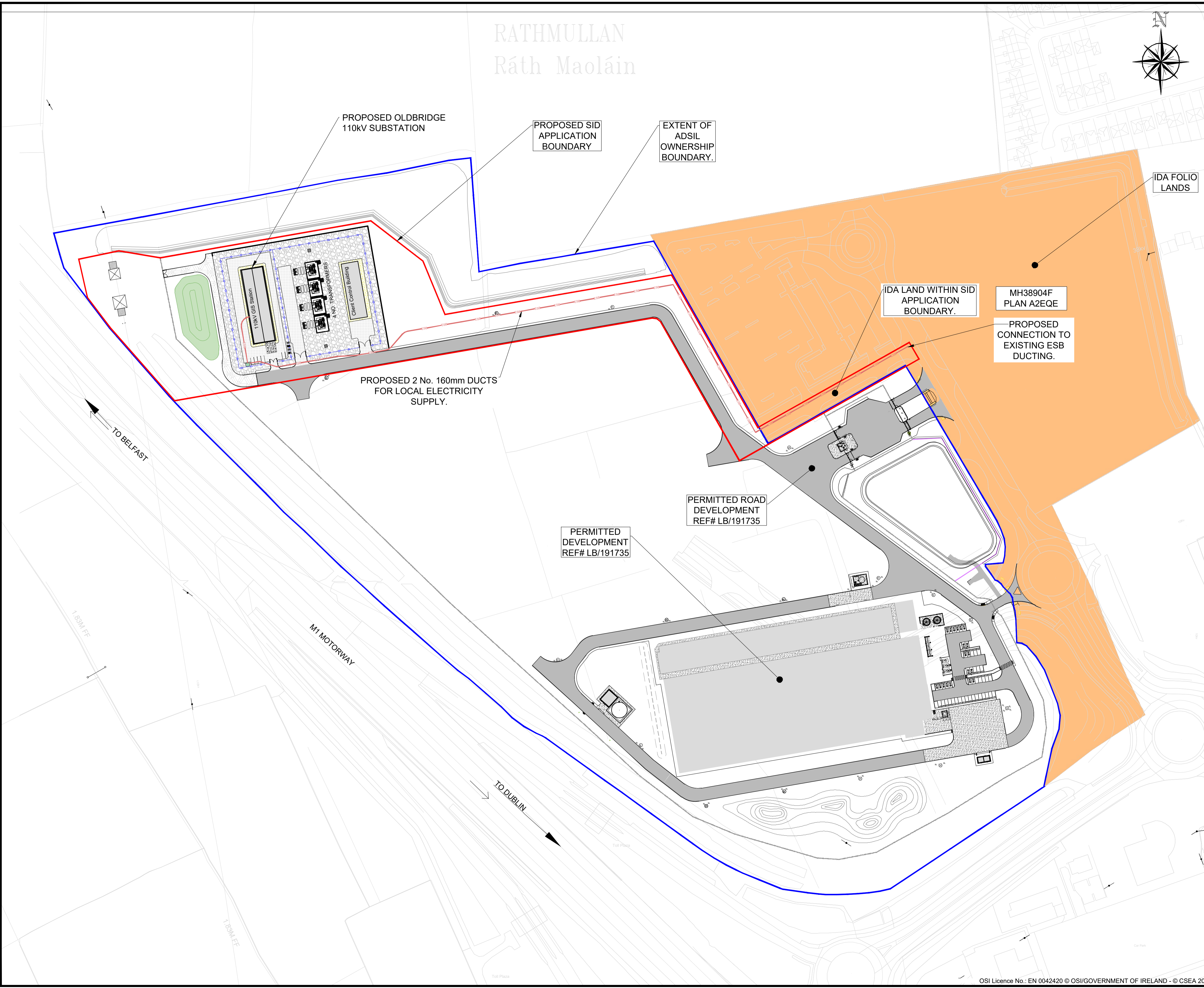

CONFIDENTIAL INFORMATION: This drawing/document and all design, details, inventions or developments covered or derived thereby are confidential and the exclusive property of the owner (or its affiliates), which reserve all rights in the drawing/document. Copying, reproduction, duplication, or distribution to a third party, in whole or in part, is forbidden unless expressly authorised in writing.

Rev	Description	Drawn	Checked	Date
P01	FOR DISCUSSION	DM	PM	03.09.2020

**Clifton Scannell Emerson Associates Limited**  
Consulting Engineers,  
Seafor Lodge,  
Castledawson Avenue,  
Blackrock, Co. Dublin,  
Ireland, A94 P768

T: +353 1 288 5006  
F: +353 1 283 3466  
E: info@csea.ie  
W: www.csea.ie

<b>Client</b>	
CAP DEVELOPMENTS LLC	
-----	
<b>Project</b>	
OLDBRIDGE 110KV SUBSTATION	
-----	
<b>Dwg. Title</b>	
EXISTING IDA OWNERSHIP AFFECTED BY PLANNING LINE	
-----	
Drawn By	DM SEPTEMBER 2020
Checked By	PM 1:1250@A1 20_057
Project Code	Originator Zone/Phase Level Type Role Dwg No.
CAP - CSE - 00 - XX - DR - C - 2130	
-----	
Status Code	Suitability Description
P01	WORK IN PROGRESS
Revision	Project Status
P01	PRELIMINARY





Amazon Data Services Ireland Limited  
One Burlington Plaza  
Burlington Road  
Dublin 4  
D04 RH96

Strategic Infrastructure Development Section  
An Bord Pleanála  
64 Marlborough Street  
Dublin 1  
D01 V902

**RE: IDA Business & Technology Park, Drogheda, Co. Meath.**

To whom it may concern,

We Amazon Data Services Ireland Limited (ADSIL), owners of the land at the IDA Business & Technology Park, Drogheda, Co. Meath, confirm that we consent to CAP Developments LLC making a Strategic Infrastructure Development application on this land.

Appended is a map (Drawing CAP-CSE-00-XX-DR-C-2130) identifying the extent of our property boundary in blue.

Yours sincerely,  
AMAZON DATA SERVICES IRELAND LIMITED

DocuSigned by:  
*James Moloney*

September 20, 2020

B2777BAC707145D...

AMAZON DATA SERVICES IRELAND LIMITED  
Registered office: ONE BURLINGTON PLAZA, BURLINGTON ROAD, DUBLIN 4, IRELAND

REGISTERED IN DUBLIN, IRELAND NO 390566  
VAT REGISTRATION NO. IE 6410566Q



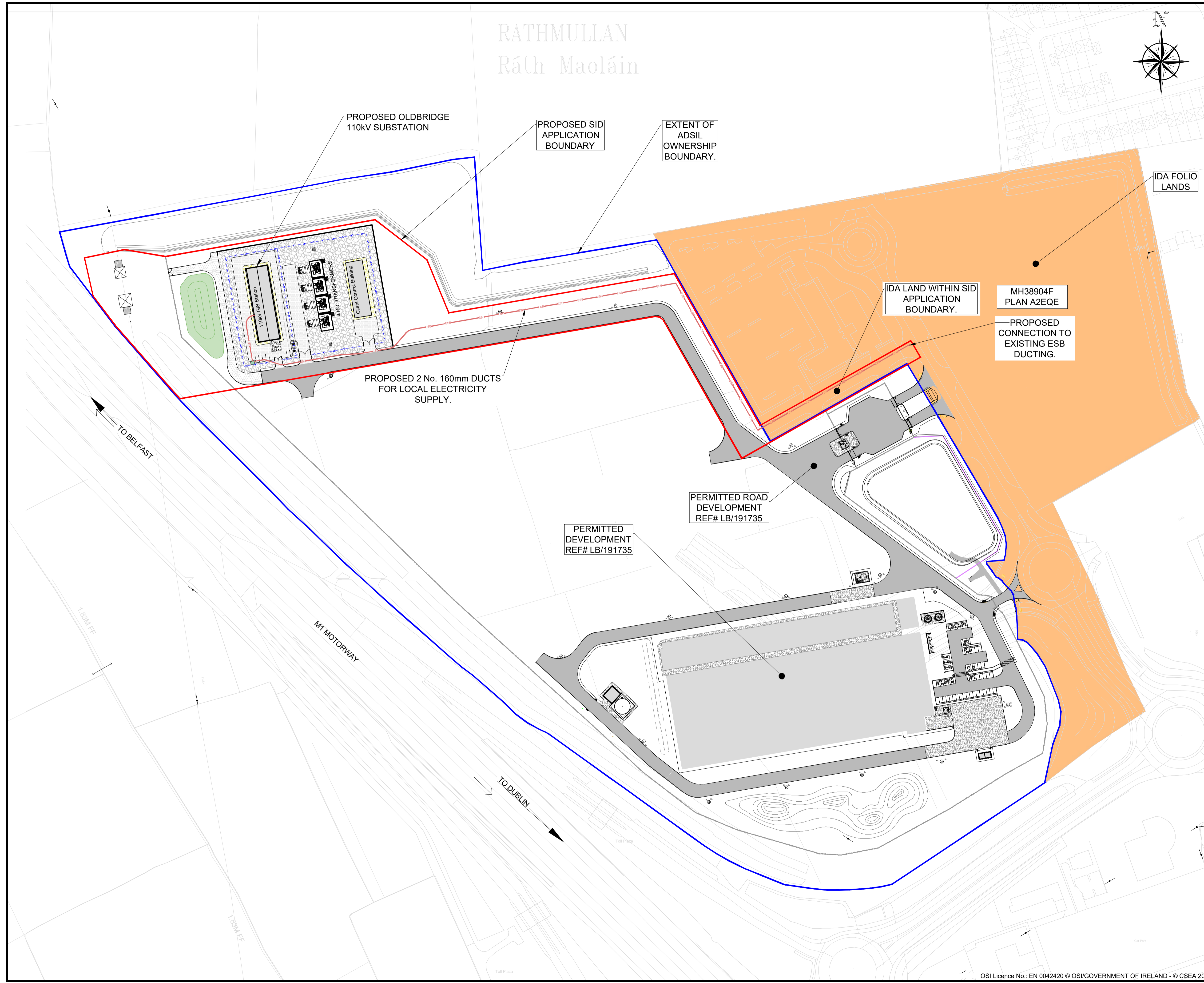

**DRAWING IS PRODUCED USING THE IRISH TRANSVERSE MERCATOR (ITM) GEOGRAPHIC COORDINATE SYSTEM**

**A1**

**LEGEND:**

- ADSIL OWNERSHIP BOUNDARY LINE
- PROPOSED PLANNING APPLICATION LINE
- IDA OWNERSHIP LAND
- PROPOSED LOCAL SUPPLY DUCT

PROPOSED OLDBRIDGE 110KV SUBSTATION

PROPOSED SID APPLICATION BOUNDARY

EXTENT OF ADSIL OWNERSHIP BOUNDARY

IDA FOLIO LANDS

IDA LAND WITHIN SID APPLICATION BOUNDARY

MH38904F PLAN A2EQE

PROPOSED CONNECTION TO EXISTING ESB DUCTING.

PROPOSED 2 No. 160mm DUCTS FOR LOCAL ELECTRICITY SUPPLY.

PERMITTED ROAD DEVELOPMENT REF# LB/191735

PERMITTED DEVELOPMENT REF# LB/191735

TO BELFAST

M1 MOTORWAY

TO DUBLIN

1:62M FF

1:31M FF

1:31M FF

CONFIDENTIAL INFORMATION: This drawing/document and all design, details, inventions or developments covered or derived thereby are confidential and the exclusive property of the owner (or its affiliates), which reserve all rights in the drawing/document. Copying, reproduction, duplication, or distribution to a third party, in whole or in part, is forbidden unless expressly authorised in writing.

P01	FOR DISCUSSION	DM	PM	03.09.2020
Rev	Description	Drawn	Checked	Date

**Clifton Scannell Emerson Associates**  
 Clifton Scannell Emerson Associates Limited  
 Consulting Engineers,  
 Seafor Lodge,  
 Castledawson Avenue,  
 Blackrock, Co. Dublin,  
 Ireland, A94 P768  
 T: +353 1 288 5006  
 F: +353 1 283 3466  
 E: info@csea.ie  
 W: www.csea.ie

**CAP DEVELOPMENTS LLC**

Client  
**OLDBRIDGE 110KV SUBSTATION**

Project  
**EXISTING IDA OWNERSHIP AFFECTED BY PLANNING LINE**

Dwg. Title

Drawn By **DM** Date **SEPTEMBER 2020** **20\_057**

Checked By **PM** Scale **1:1250 @ A1** CSEA Job No.

Project Code	Originator	Zone/Phase	Level	Type	Role	Dwg No.
<b>CAP - CSE - 00 - XX - DR - C - 2130</b>						

**S0** WORK IN PROGRESS  
 Status Code Suitability Description

**P01** PRELIMINARY  
 Revision Project Status

OSI Licence No.: EN 0042420 © OSI/GOVERNMENT OF IRELAND - © CSEA 2020